

CONFERENCE IN THE CITY, COUNTRY OR ON THE COAST?



WE'VE GOT JUST THE PLACE

MELBOURNE CBD | YARRA VALLEY | TORQUAY | MORNINGTON PENINSULA
GOLDFIELDS | INVERLOCH | NOOSA | GOLD COAST | HOBART



RACV Torquay Resort



RACV Goldfields Resort

DISCOVER THE POSSIBILITIES

Whether you're looking for ocean views, inner city energy, or peaceful tranquillity, RACV Conferences and Events can provide the perfect destination with nine properties across Victoria, Queensland and Tasmania.



RACV Hobart Hotel



RACV Cape Schanck Resort



RACV Healesville Country Club & Resort



RACV Royal Pines Resort



RACV City Club



RACV Inverloch Resort



RACV Noosa Resort



RACV CAPE SCHANCK RESORT

Located only 75-minutes from Melbourne CBD, RACV Cape Schanck Resort offers a sophisticated destination combining stunning ocean views with versatile, cutting-edge event spaces. The venue's seamless integration of modern design with its natural surroundings makes it an inspiring choice for any event.

CONFERENCE FACILITIES

- 10 conference rooms with natural light
- 2 pre-function areas
- Green room
- Breakout areas
- Complimentary Wi-Fi
- AV equipment

ACCOMMODATION

- 204 rooms, including:
 - 120 rooms and suites with ocean and/or golf views in the main building
 - 16 two- and three-bedroom villas
 - 48 ocean view rooms
- Amenities:
 - Complimentary Wi-Fi
 - Widescreen TV
 - In-room media hub
 - Mini bar
 - 24-hour room service
 - TV casting

DINING

- Cape – premium restaurant
- Samphire – breakfast and a la carte restaurant
- Mantellina – casual cafe / restaurant
- Bar and lounge – drinks and snacks

GUEST SERVICES

- Golf shop
- Undercover parking
- Electric car charging stations

RECREATION FACILITIES

- Championship 18-hole golf course
- Practice facilities
- Floodlit tennis courts
- Gym and group fitness room
- Day spa
- Driving range
- Indoor swimming pool, spa and sauna
- Games room

ATTRACTIONS

- Coastal walks
- World class wineries
- Hot springs and thermal bathing locations
- Enchanted Adventure
- Nearby markets, galleries and shopping
- On-site beach access

CONTACT

Call (03) 5950 8029 or email capeschanck_conference@racv.com.au



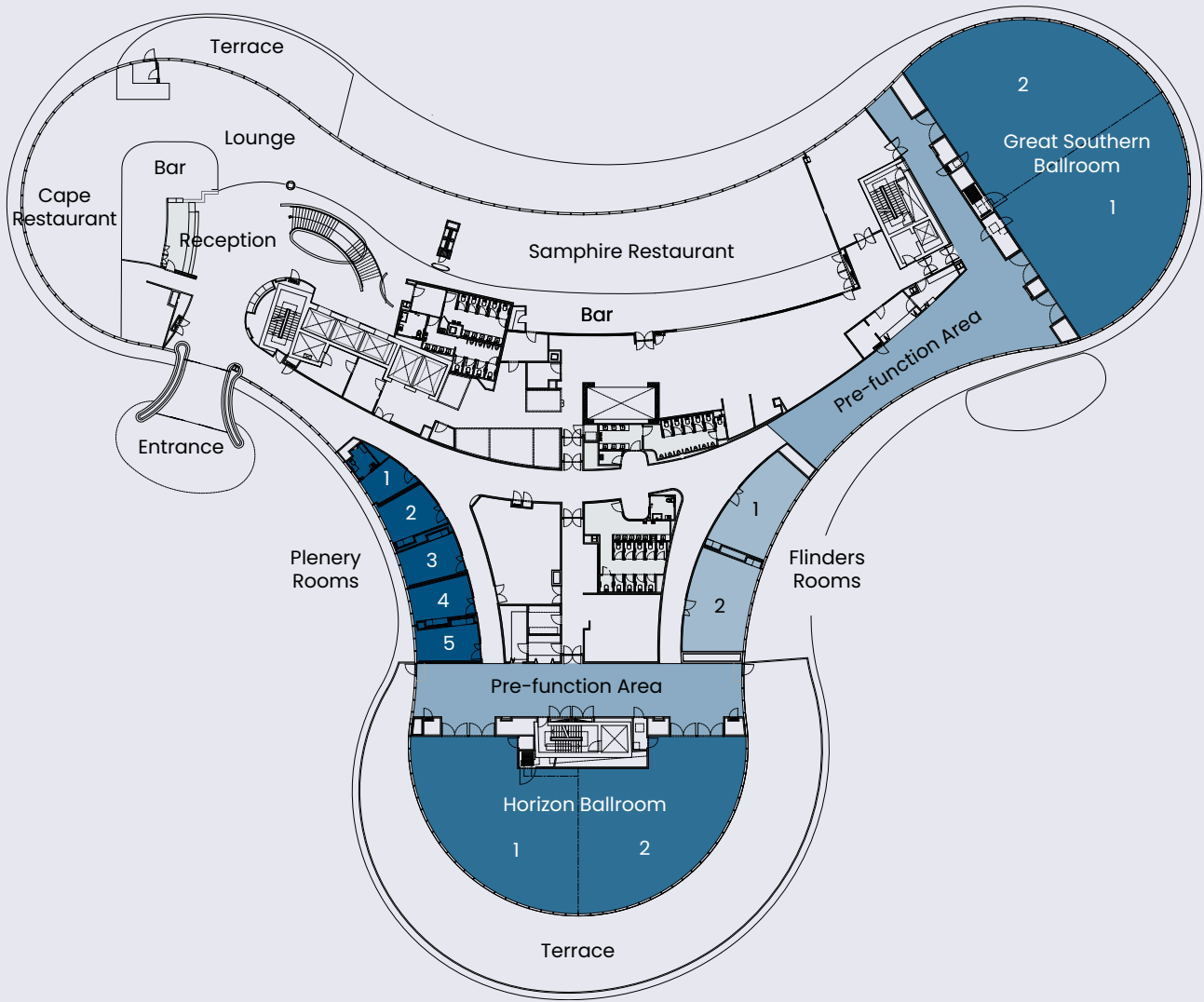

CAPACITIES

ROOM	AREA (m2)	COCKTAIL STYLE	BANQUET STYLE	CABARET STYLE	THEATRE STYLE	C'ROOM STYLE	B'ROOM STYLE	U SHAPE STYLE	DINNER DANCE	EXHIBITION BOOTHS (3m x 3m)
Great Southern Ballroom	483	450	300	240	450	200	220	-	240	26
GSB Pre Function Area	233	-	-	-	-	-	-	-	-	5
Great Southern Ballroom 1	241	225	150	120	225	100	85	50	110	13
Great Southern Ballroom 2	241	225	150	120	225	100	85	50	110	13
Horizon Ballroom	382	370	200	160	340	120	190	-	160	16
HB Pre Function Area	159	-	-	-	-	-	-	-	-	4
Horizon Ballroom 1	191	185	90	72	170	60	95	35	60	8
Horizon Ballroom 2	189	185	90	72	170	60	95	35	60	8
Flinders 1	48	-	30	24	40	20	20	20	-	-
Flinders 2	54	-	30	24	40	20	20	24	-	-
Bass 2 -5	20	-	-	-	-	-	10	-	-	-
Banksia Room	120	80	-	60	-	-	-	-	-	-



RACV GOLDFIELDS RESORT

Explore RACV Goldfields Resort, a hidden gem just 90 minutes from Melbourne, nestled between Daylesford and Ballarat. Set on 150 acres of state forest in Creswick, the resort offers extensive indoor and outdoor event spaces, perfect for hosting a large-scale conference or team event bringing nature, space, and business together.

CONFERENCE FACILITIES

- Capacity for 10 to 600 guests
- 10 versatile function areas
- Pillarless ballroom
- 3 secretariat rooms
- Complimentary Wi-Fi
- High-quality AV equipment with in-house technicians
- Dedicated event coordinators
- Extensive lawn areas for team building exercises

ACCOMMODATION

- 136 accommodation rooms with forest or golf views
- One and two bedroom suites available
- Complimentary Wi-Fi
- Widescreen TV
- 24-hour reception

DINING

- Three Founders restaurant
- Springs Bar & Terrace
- Fairway Lounge

GUEST SERVICES

- Golf shop
- Car park
- Electric car charging stations

RECREATION FACILITIES

- 18-hole golf course & putting green
- Gym, heated swimming pool and spa
- Tennis courts
- BBQ area
- 6.3km mountain bike trails

ATTRACTIONS

- Sovereign Hill
- Ballarat & Daylesford
- Creswick Woollen Mills
- Hepburn Springs
- Nearby markets, galleries and shops

CONTACT

Call (03) 5345 9600 or email events_goldfields@racv.com.au



FACILITIES AND LAYOUT

RACV Goldfields Resort offers versatile function rooms for meetings and events of any size. Our dedicated team ensures a seamless experience, handling everything from planning and room setup to catering and accommodation. With flexible layouts and seating options, we tailor each space to your needs. Whether it's a conference, wedding, celebration, or corporate event, we deliver every detail with care and expertise.

GROUND FLOOR



PEPPERBERRY ROOM Ground Floor

- Floor to ceiling windows
- Large doors to terrace, gardens
- and large grassed area
- Heating & air conditioning
- Max 64 pax theatre style.

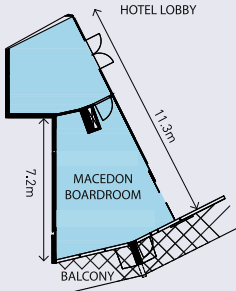

MACEDON ROOM Level 1

- Floor to ceiling windows with forest and golf course views
- Access to balcony
- Heating & air conditioning
- Video conferencing system
- Max 12 pax boardroom style.

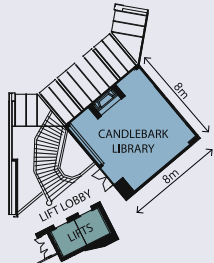

CANDLEBARK LIBRARY Level 2

- Natural light
- Fireplace
- Heating & air conditioning
- Max 40 pax theatre style

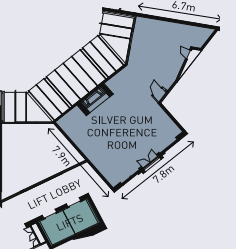

SILVER GUM ROOM Level 2

- Natural light
- Fireplace
- Heating & air conditioning
- Max 60 pax theatre style



CAPACITIES

ROOM	HEIGHT (m)	AREA (m2)	COCKTAIL STYLE	BANQUET STYLE	CABARET STYLE	THEATRE STYLE	C'ROOM STYLE	B'ROOM STYLE	U SHAPE STYLE	DINNER DANCE
Grand Ballroom	2.7-3.5	537.9	600	400	320	600	360	-	-	340
Hepburn	2.7-3.5	179.3	180	100	64	170	120	-	60	-
Creswick	2.7-3.5	179.3	180	100	64	170	120	-	60	-
Lindsay	2.7-3.5	179.3	180	100	64	170	120	-	60	-
Hepburn Foyer	3.5	132.0	180	-	-	-	-	-	-	-
Lindsay Foyer	3.5	67.1	100	-	-	-	-	-	-	-
Macedon Boardroom	3.1	36.0	-	-	-	-	-	14	-	-
Pepperberry	3.0	71.7	70	50	40	64	45	20	24	-
Candlebark Library	2.7	58.4	35	24	24	40	24	18	20	-
Silver Gum	2.7	88.2	-	24	24	60	24	18	21	-
Ironbark	3.0	103.5	100	60	48	84	60	40	35	-
Banksia	3.0	184.0	150	130	80	140	84	42	40	-

*Please note maximum capacities do not include staging or dance floor.



RACV HEALESVILLE COUNTRY CLUB & RESORT

Located in the heart the of Yarra Valley and only an hour's drive from Melbourne's CBD, RACV Healesville Country Club & Resort offers a wide selection of conference and event choices. Our property has an extensive range of facilities that will ensure you'll have everything you need to make your event a success, while you enjoy the breath-taking scenery of the Great Dividing Range.

CONFERENCE FACILITIES

- 200 seat function room
- 15 function rooms
- Outdoor terraces and balcony access
- Grand Conservatory with stunning views of Mt Riddell
- Breakout areas
- Complimentary Wi-Fi
- High-quality AV equipment

ACCOMMODATION

- 80 premium accommodation rooms
- Private balconies/patios with mountain, garden or golf course views
- Complimentary Wi-Fi
- 24-hour reception and room service
- Widescreen TV
- TV casting

DINING

- 2 restaurants
- 2 bars

GUEST SERVICES

- Undercover parking
- Lobby shop
- Electric car charging stations

RECREATION FACILITIES

- 18-hole golf course
- 4-hole short course
- 4 tennis courts, 2 floodlit for night games
- Gym
- Day spa
- Indoor swimming pool
- Spa, sauna and steam room
- Bowling green
- Croquet lawn
- Bocce court

ATTRACTIONS

- Walking trails- National Parks Badgers Weir and Centennial Trail Donnelly's Weir
- Healesville Sanctuary
- Hot air balloon flights
- Four Pillars gin distillery
- Payten & Jones winery
- Watts River Brewery
- TarraWarra Museum of Art

CONTACT

Call (03) 5969 9462 or email
healesvilleevents@racv.com.au



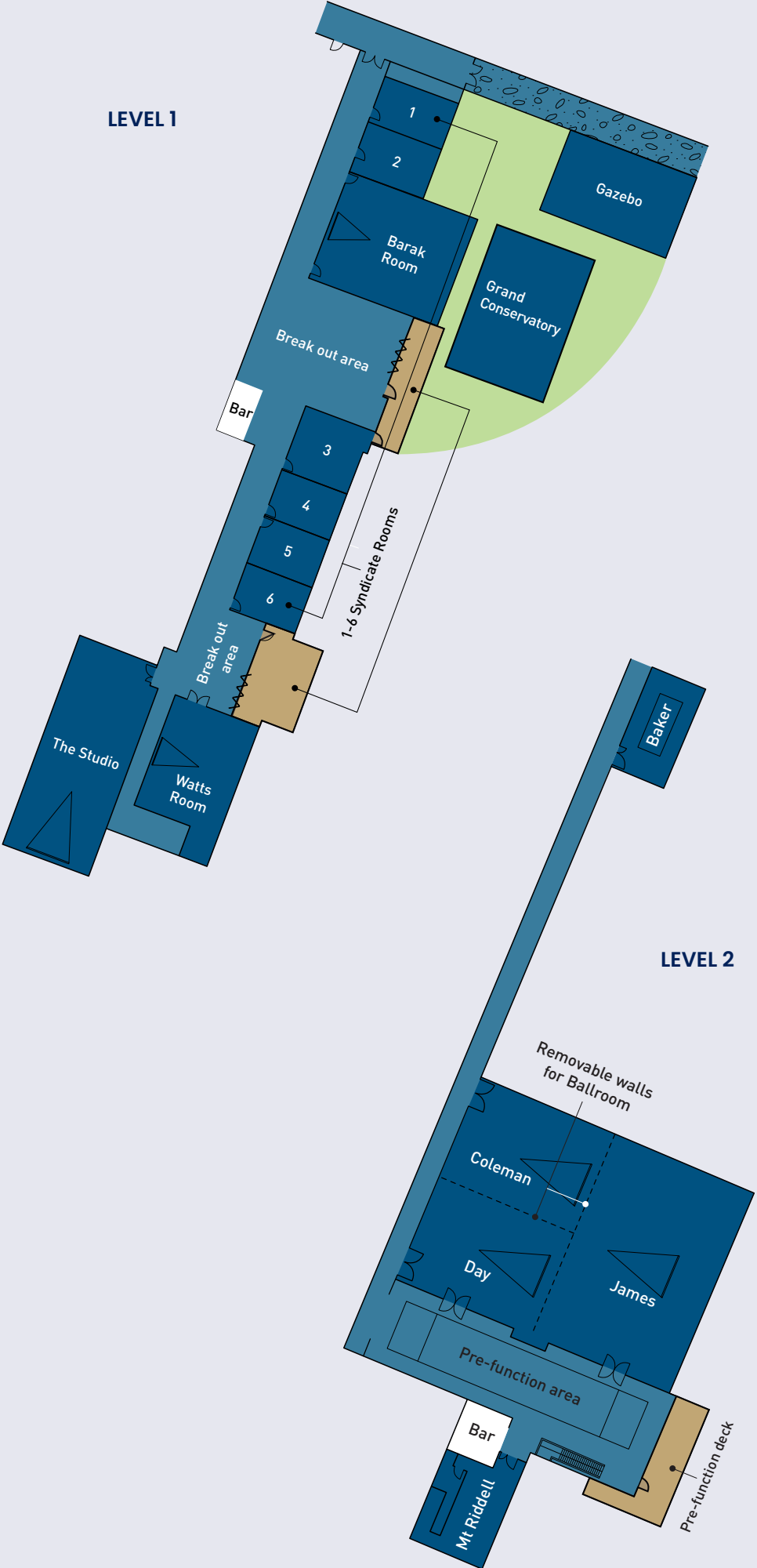

CAPACITIES

ROOM	HEIGHT (m)	AREA (m2)	COCKTAIL STYLE	BANQUET STYLE	CABARET STYLE	THEATRE STYLE	C'ROOM STYLE	B'ROOM STYLE	U SHAPE STYLE	DINNER DANCE
Ballroom James / Day / Coleman	3.7	400	320	240	196	320	150	52	63	220
James	3.7	204	160	120	84	180	75	30	33	100
Day or Coleman	3.7	98	70	60	42	70	32	22	21	40
Baker	2.7	38	-	-	-	-	-	14	-	-
Mt Riddell	2.7	26	-	-	-	-	-	6	-	-
Watts	2.7	73	60	50	35	70	32	22	21	40
Barak	2.7	95	70	60	42	96	45	28	24	50
Syndicate 1	2.7	26	-	-	-	18	12	11	9	-
Syndicate 2	2.7	22	-	-	-	12	-	8	6	-
Syndicate 3	2.7	34	-	-	-	18	12	11	11	-
Syndicate 4	2.7	24	-	-	-	12	-	8	6	-
Syndicate 5	2.7	24	-	-	-	12	-	8	6	-
Syndicate 6	2.7	24	-	-	-	12	-	8	6	-
Gazebo	2.76	64	40	20	-	-	-	-	-	-
Grand Conservatory	2.4	210	100	80	-	-	-	-	-	60



RACV INVERLOCH RESORT

Nestled in the heart of Victoria's spectacular South Gippsland coast, with sweeping views of Bass Strait and Anderson Inlet, is RACV Inverloch Resort. With direct beach access, floor-to-ceiling windows, and serene coastal surroundings, the resort provides an environment ideal for engaging minds. Your perfect venue for events both large and small.

CONFERENCE FACILITIES

- 200 seated banquet room with multiple configurations available
- 2 ocean-view boardrooms accommodating up to 20 guests
- Break-out rooms
- Complimentary Wi-Fi
- High-quality AV equipment

ACCOMMODATION

- 25 resort rooms
- 26 ocean-view rooms
- 20 two and three bedroom villas
- 20 two bedroom deluxe cabins
- Complimentary Wi-Fi
- Widescreen TV
- Room service

DINING

- Restaurant
- Lounge bar
- Outdoor BBQ

GUEST SERVICES

- Lobby shop
- Car parking
- Electric car charging stations

RECREATION FACILITIES

- Indoor swimming pool
- Spa & sauna
- Tennis courts
- Gym
- Games room
- Walking trails

ATTRACTIONS

- Leongatha 18-hole golf course
- Wineries
- Anderson Inlet beach
- Bunurong Coast Marine Park
- Nearby markets, galleries and shops
- State Coal Mine
- Wilsons Prom day trips
- Prom Country Cheeses

CONTACT

Call (03) 5674 0000 or email inverlochevents@racv.com.au





LEVEL 1

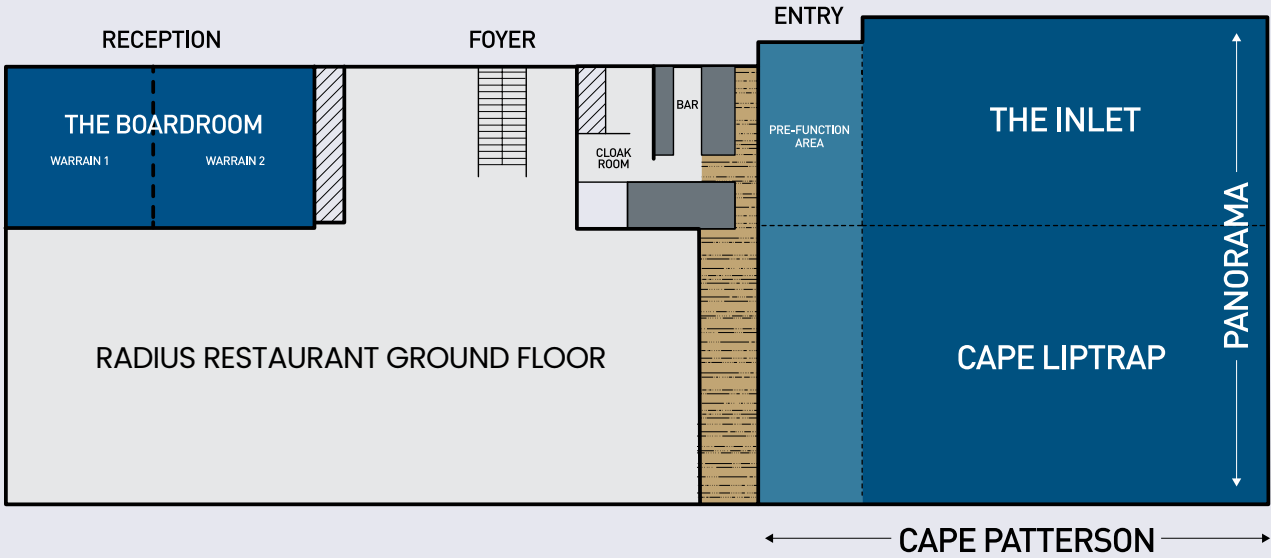

Main plenary room is a flexible event space that can be divided into multiple spaces forming the below room configurations

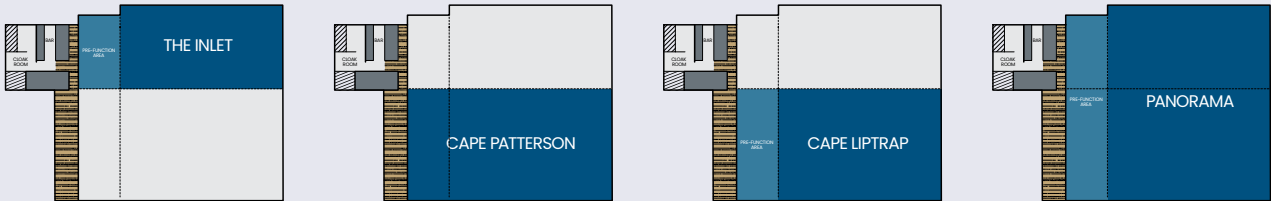

CAPACITIES

ROOM	HEIGHT (m)	AREA (m2)	COCKTAIL STYLE	BANQUET STYLE	CABARET STYLE	THEATRE STYLE	C'ROOM STYLE	B'ROOM STYLE	U SHAPE STYLE	DINNER DANCE
The Inlet	3.5	116	100	60	42	120	60	40	35	-
Cape Liptrap	3.5	152	160	90	63	160	80	50	40	-
Cape Paterson	3.5	200	180	120	84	200	100	60	50	-
Panorama	3.5	352	280	200	140	250	150	80	60	180
Warrain 1	2.9	30	-	-	-	-	-	10	-	-
Warrain 2	2.9	30	-	-	-	-	-	10	-	-
Recreation Room	2.9	122	50	30	-	40	30	20	20	-
The Boardroom	2.9	60	-	20	-	-	-	20	-	-



RACV TORQUAY RESORT

At the gateway to one of the world's most stunning coastal drives, RACV Torquay Resort, is a 75 minute trip from Melbourne's CBD and only 40 minutes from Avalon Airport. The resort offers contemporary event spaces and outdoor terrace with panoramic ocean views. Whether it's a conference, cocktail party, or product launch, Torquay provides the perfect backdrop

CONFERENCE FACILITIES

- 10 versatile function areas for up to 410 people
- 340 seat pillarless ballroom
- 3 pre-function areas
- Private outdoor terrace
- Complimentary Wi-Fi
- High-quality AV equipment
- Dedicated event coordinators

ACCOMMODATION

- 92 accommodation rooms with ocean or golf views
- Complimentary Wi-Fi
- Widescreen TV
- TV casting
- 24-hour reception and room service

DINING

- Restaurant
- Bistro
- Bar

GUEST SERVICES

- Lobby shop
- Undercover parking
- Golf shop
- Electric car charging stations

RECREATION FACILITIES

- 18-hole golf course
- Day spa
- Gym, indoor swimming pool and spa
- Sauna
- Floodlit tennis courts
- Games room with pool table, table tennis and arcade games

ATTRACTIONS

- Beaches
- Wineries
- Walking trails
- Great Otway National Park
- Nearby coastal townships

CONTACT

Call (03) 5261 1600 or email events_torquay@racv.com.au





CAPACITIES

ROOM	HEIGHT (m)	AREA (m2)	COCKTAIL STYLE	BANQUET STYLE	CABARET STYLE	THEATRE STYLE	C'ROOM STYLE	B'ROOM STYLE	U SHAPE STYLE	DINNER DANCE
Great Ocean Road Ballroom	3.2 - 4.3	474	410	270	216	340	220	-	-	240
Rincon Room	3.2 - 4.3	233	150	110	80	140	100	-	-	80
Winkipop Room	3.2 - 4.3	240	170	120	88	150	110	-	-	90
Zeally Room 1	3.4	135	100	90	56	96	60	36	30	-
Zeally Room 2	3.4	24	-	-	-	-	-	10	-	-
Zeally Room 3	3.4	48	-	-	16	30	-	20	20	-
Bells Room 1	3.4	114	80	50	40	72	45	36	25	-
Bells Room 2	3.4	27	-	-	-	-	-	10	-	-
Bells Room 3	3.4	27	-	-	-	-	-	10	-	-
Bells Room 4	3.4	37	-	-	-	-	-	14	-	-

*Please note maximum capacities do not include staging or dance floor.

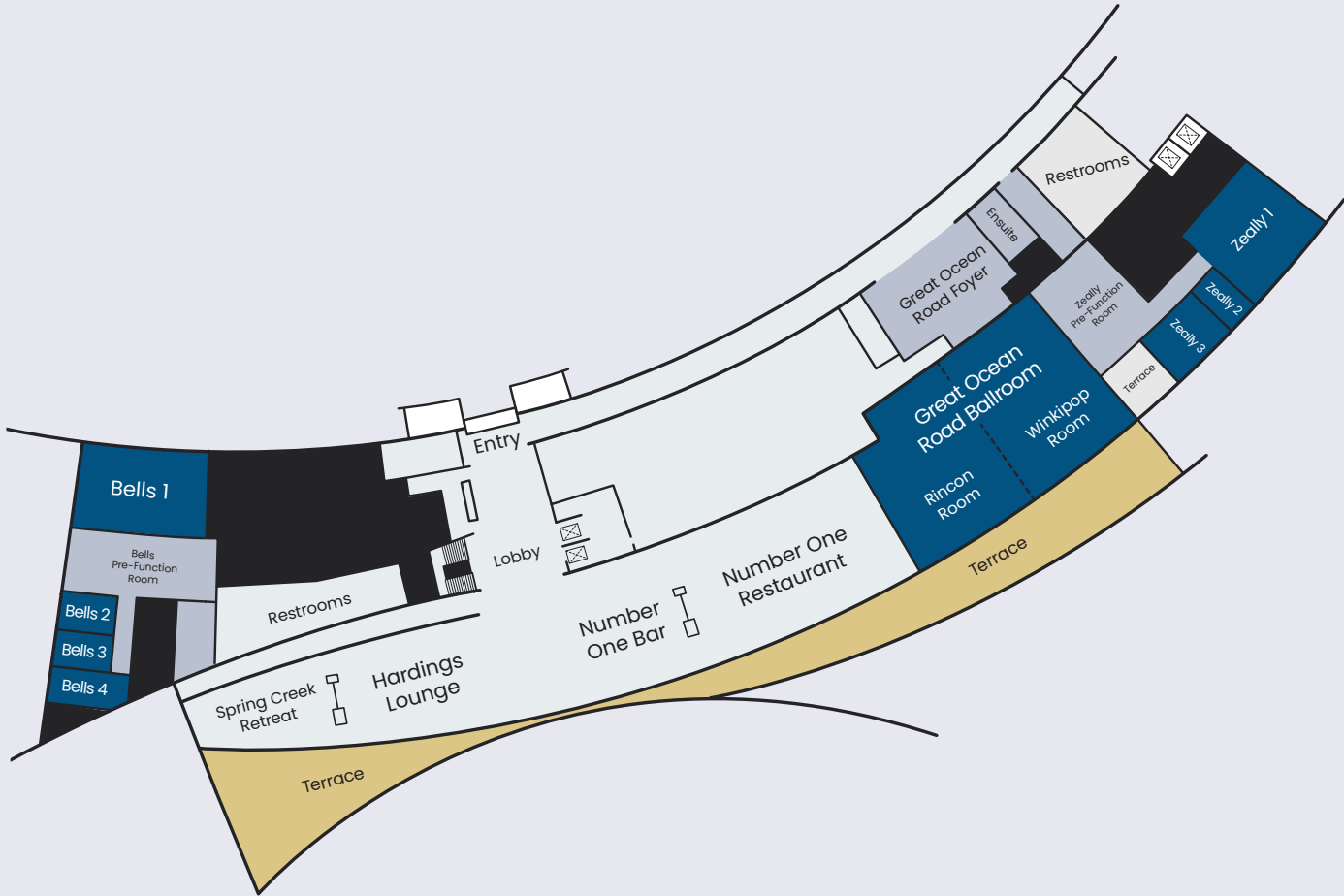



RACV CITY CLUB

RACV City Club, in the heart of Melbourne's CBD, is urban elegance with the city at your doorstep. With varied meeting spaces, a rooftop pillarless ballroom, and an outdoor terrace, this venue is where new ideas start. The hotel offers a variety of dining options, a fitness centre, swimming pool, squash courts and a day spa.

CONFERENCE FACILITIES

- 500 seat function room
- 260 seat Club Pavilion
- 31 seat luxury theatre
- 20 seat intimate wine cellar
- 7 multi-configurable meeting rooms
- 200 seat cocktail bar
- Outdoor terraces with spectacular views
- Complimentary Wi-Fi
- High-quality AV equipment with on-site technicians

ACCOMMODATION

- 134 elegant rooms and suites
- 24-hour room service
- Widescreen TV
- TV casting
- Internet access

DINING

- 8 restaurants and bars
- 2 private dining rooms

GUEST SERVICES

- Fully-equipped Shared Working Space
- Valet parking
- 460 undercover car spaces
- Electric car charging stations

RECREATION FACILITIES

- Gym
- Day spa
- Indoor swimming pool
- Steam room
- Sauna
- Squash courts
- Billiards room
- Library

ATTRACTIONS

- Cooking Master Class
- Kitchen tours with our Executive Chef
- Billiards, Snooker or Pool lesson with our resident professional
- Close to city shopping, theatres, public transport and sporting venues
- Tours of the MCG and Queen Victoria Market
- Eureka Skydeck
- Melbourne Star Observation Wheel
- Yarra River Cruises

CONTACT

Call 1300 139 059 or email conferencesandevents@racv.com.au



LEVEL 17

- 1. Function room
- 2. Outdoor terrace
- 3. Pre-function lounge
- 4. Restrooms
- 5. Green room

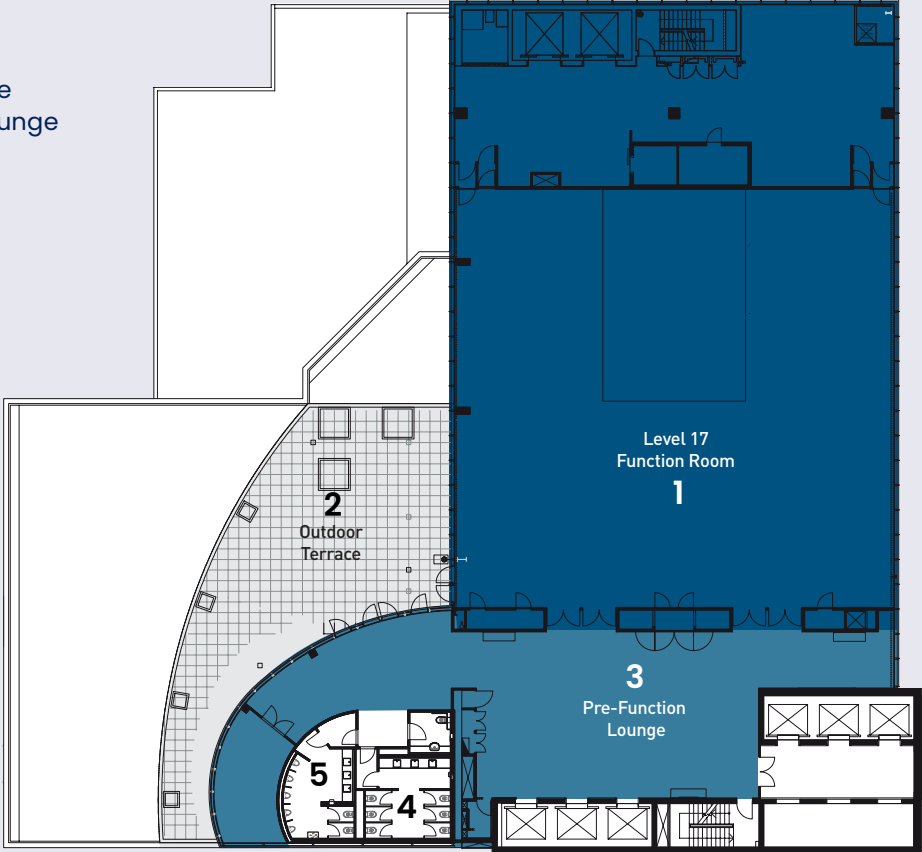

CAPACITIES

ROOM	HEIGHT (m)	AREA (m2)	COCKTAIL STYLE	BANQUET STYLE	CABARET STYLE	THEATRE STYLE	C'ROOM STYLE	B'ROOM STYLE	U SHAPE STYLE	DINNER DANCE	EXHIBITION BOOTHS (3m x 2.5m)
Level 17 Function Room	5	593	500	400	288	500	228	-	-	350	24
Level 17 Pre-function Lounge	-	-	200	-	-	-	-	-	-	-	-
Level 2 Bayside Room 4	3.5	250	190	80	64	120	54	48	-	-	-
Level 2 One Room	3.5	80	60	50	40	60	36	18	24	-	-
Level 2 Two Rooms	3.5	158	140	100	80	120	84	54	48	60	-
Level 2 Three Rooms	3.5	229	200	150	120	180	120	72	72	100	-
Club Pavilion	3	228.8	200	120	96	260	102	-	54	100	-
Theatrette	3.25	58	-	-	-	31	-	-	-	-	-
Wine Cellar	2.4	73	20	-	-	-	-	20	-	-	-

LEVEL 2

- 1. Outdoor Bayside Terrace
- 2. Shared Working Space
- 3. Pre-function breakout area
- 4. Club Pavilion
- 5. Club Pavilion Pre-Function Area
- 6. Outdoor Club Pavilion Terrace
- 7. Outdoor Bourke Terrace

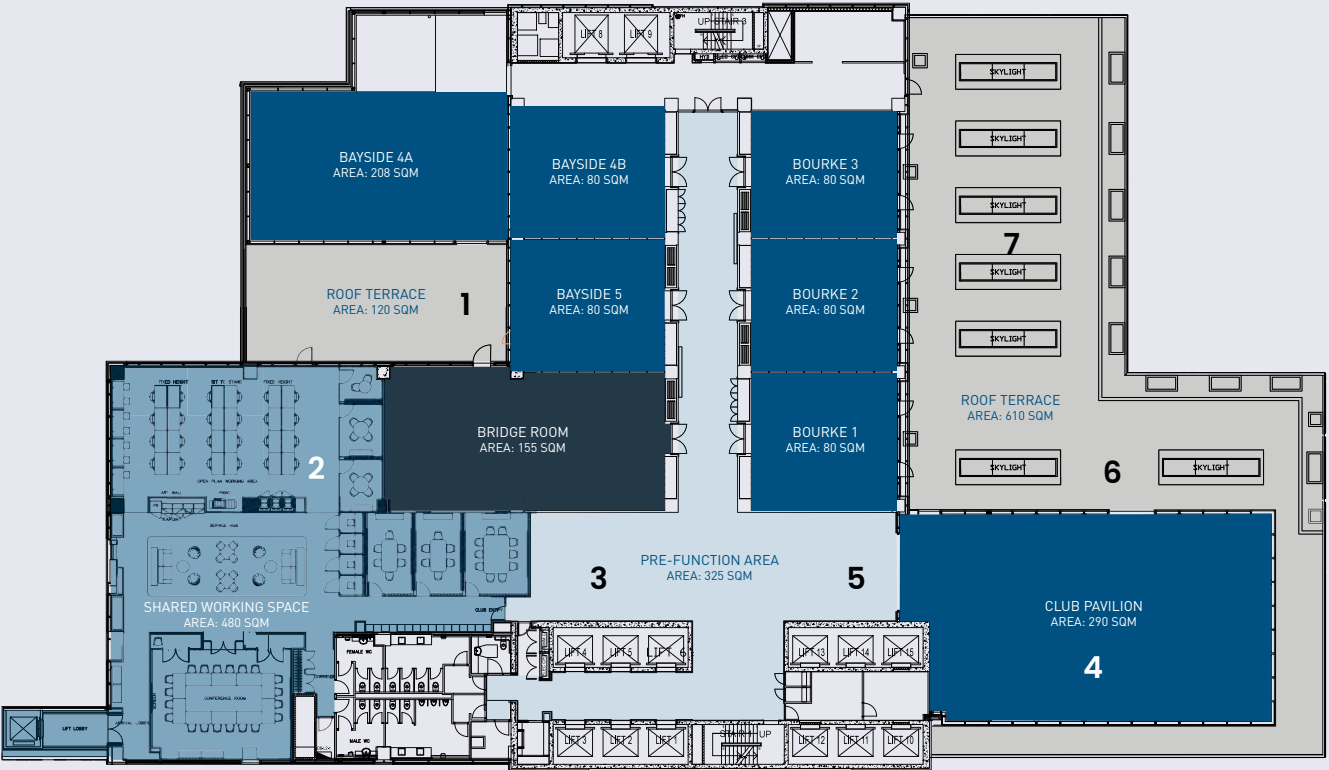



RACV HOBART HOTEL

Nestled in the heart of Hobart CBD, RACV Hobart Hotel has the contemporary facilities you need alongside the historical charm of Tasmania's capital. Whether it's a corporate retreat or a networking function, the unique character of the hotel makes it a memorable place for doing business.

CONFERENCE FACILITIES

- 220 seated conference or 120 seated banquet room
- Range of flexible room set-ups
- Pre-function area with natural light
- Complimentary Wi-Fi
- High-quality AV equipment

ACCOMMODATION

- 125 accommodation rooms overall
- 70 standard hotel room
- 45 apartment style rooms
- 10 premium apartments
- Complimentary Wi-Fi
- Widescreen TV

DINING

- Charcoal Restaurant
- Cascade on Collins

GUEST SERVICES

- Undercover Parking for In-house guests
- Electric car charging stations

RECREATION FACILITIES

- 24 hour Gym

ATTRACTIONS

- MONA art gallery
- Salamanca market
- Mt Field bushwalking
- Mt Wellington
- Constitution dock
- Nearby markets, galleries and shops

CONTACT

Call (03) 6270 8600 or email events_hobart@racv.com.au





CAPACITIES

ROOM	HEIGHT (m)	AREA (m2)	COCKTAIL STYLE	B'ROOM STYLE	C'ROOM STYLE	THEATRE STYLE	U SHAPE STYLE	CABARET STYLE	BANQUET STYLE	BANQUET W/ DANCE FLOOR	BANQUET W/ HEAD TABLE	BANQUET W/ DANCE FLOOR & HEAD TABLE
Collins Room	2.7	205	220	60	80	140	40	110	120	110	120	100
The Stables	2.65	127	110	30	38	120	25	64	80	60	70	60
Boardroom	2.6	45	-	16	-	-	-	-	-	-	-	-
Executive Lounge	2.6	70	35	12	-	-	-	-	-	-	-	-

*Please note maximum capacities do not include staging or dance floor.



RACV NOOSA RESORT

Situated on Queensland's Sunshine Coast and overlooking a pristine wetlands sanctuary, RACV Noosa Resort is just 30 minutes' drive from Sunshine Coast Airport and 90 minutes from Brisbane Airport. The resort offers a tropical paradise perfect for a complete property takeover. Close to the iconic beaches of Noosa, this venue provides a harmonious blend of professional focus and relaxation, ensuring attendees leave refreshed and inspired.

CONFERENCE FACILITIES

- 150 seat ballroom
- 4 versatile meeting rooms
- Alfresco and undercover break-out areas
- Complimentary Wi-Fi

ACCOMMODATION

- 338 bedrooms and bathrooms consisting of;
 - 24 one bedroom suites
 - 30 one bedroom apartments
 - 54 two bedroom, two bathroom apartments
 - 24 three bedroom, three bathroom apartments
 - 26 three bedroom villas
 - 13 three bedroom luxury enclave villas
- Complimentary Wi-Fi
- Widescreen TV
- TV casting
- Room service

DINING

- Restaurant
- Bar
- Pizzeria

GUEST SERVICES

- Lobby shop
- Complimentary car parking
- Complimentary shuttle bus to Hastings Street
- Electric car charging stations

RECREATION FACILITIES

- Gym
- Day spa
- Heated swimming pool
- Floodlit tennis courts
- Bike hire

ATTRACTIONS

- Walking trails
- Beach
- National parks
- Fraser Island
- Australia Zoo
- Nearby markets, galleries and shops

CONTACT

Call 1300 273 962 or email
eventsnoosa@racv.com.au



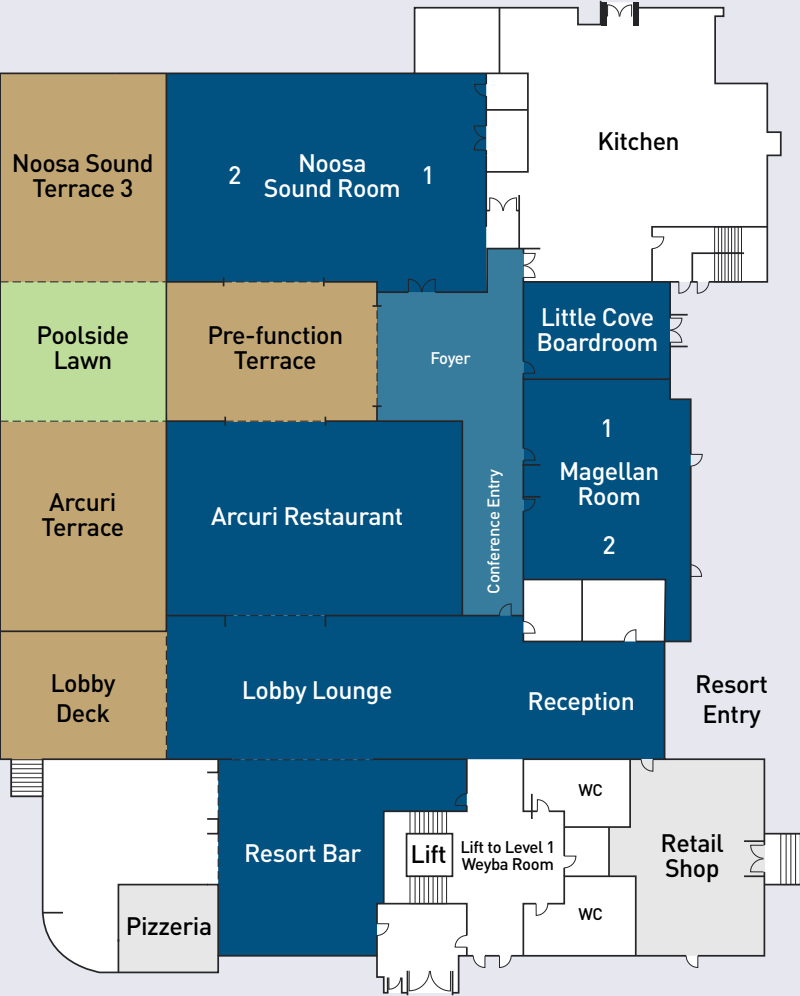

CAPACITIES

ROOM	HEIGHT (m)	AREA (m2)	LONG TABLES	COCKTAIL STYLE	BANQUET STYLE	CABARET STYLE	THEATRE STYLE	C'ROOM STYLE	B'ROOM STYLE	U SHAPE STYLE
Noosa Sound 1	2.7	91	-	-	60	48	60	36	28	33
Noosa Sound 2	2.7	91	-	-	60	48	60	36	28	33
Noosa Sound 3	2.7	71	-	50	60	35	50	24	24	21
Noosa Sound 1 & 2	2.7	182	-	200	120	98	150	72	-	-
Noosa Sound Whole (1, 2 & 3)	2.7	253	-	250	170	133	200	-	-	-
Magellan 1	2.7	49.5	-	-	24	21	30	18	16	16
Magellan 2	2.7	49.5	-	-	24	21	30	18	16	16
Magellan 1 & 2	2.7	99	-	-	60	42	60	24	20	18
Weyba Room	2.7	86	-	-	48	42	50	27	24	24
Little Cove	2.7	37.5	-	-	-	-	-	12	18	16
Indoor Terrace	2.7	86.5	-	150	60	-	50	-	-	-
Arcuri Restaurant	2.7	118	100	200	-	-	-	-	-	-
Acuri Terrace	2.7	90	44 (4 tables 11 pax)	50	-	-	-	-	-	-



RACV ROYAL PINES RESORT

In the heart of Queensland's Gold Coast sits RACV Royal Pines Resort. Only an hour from Brisbane Airport and just 25 minutes from Gold Coast Airport, the resort is a standout for large-scale conferences and events. Featuring the largest hotel LED screen in the Southern Hemisphere and 15 flexible and impressive event spaces, Royal Pines takes events to the next level, transforming ordinary gatherings into extraordinary experiences.

CONFERENCE FACILITIES

- 1500 seated conference venue or 880 seated banquet with multiple configurations available
- Ballroom with state of the art 24 metre wide LED screen
- 15 versatile function rooms
- 8 meeting rooms with floor to ceiling windows
- Undercover tennis courts for unique dining events
- Complimentary Wi-Fi
- State of the art audio visual company with on-site technicians

ACCOMMODATION

- 333 Accommodation rooms consisting of:
 - 42 Mountain View rooms
 - 36 Deluxe Mountain View rooms
 - 154 Superior rooms (60 King & 94 twin)
 - 37 Spa Suites
 - 3 Family Suites
 - 48 Executive rooms
 - 9 Executive Spa Suites
 - 3 Executive Suites
 - 1 Torquay Suite
- Complimentary WiFi
- Widescreen TV
- TV casting
- Mini bar fridge
- Room service and 24-hour reception

DINING

- 8 restaurants and bars

GUEST SERVICES

- Golf and Lobby shop
- Car parking with electric car charging stations

RECREATION FACILITIES

- 27-hole golf course including championship course and driving range
- Waterpark
- Floodlit, undercover tennis courts
- Gym and day spa
- Large tropical swimming pool and spa
- Expansive lawn areas for team building

ATTRACTIONS

- Private golf tuition
- Gold Coast Theme Parks
- Wildlife sanctuary
- Rainforest
- Q1 observation deck
- Cruises and jet boats
- Carrara stadium

CONTACT

Call (07) 5597 8700 or email
royalpines_sales@racv.com.au



FACILITIES AND LAYOUT

RACV Royal Pines Resort offers versatile rooms for meetings and events of any size. Our dedicated team manages every detail, from room setup and breakout spaces to catering and accommodation.

With flexible layouts and seating options, we tailor each space to your needs. Spread over two levels, our conferencing facilities include 15 meeting rooms across three main sections, ensuring endless possibilities for your event.



GROUND LEVEL

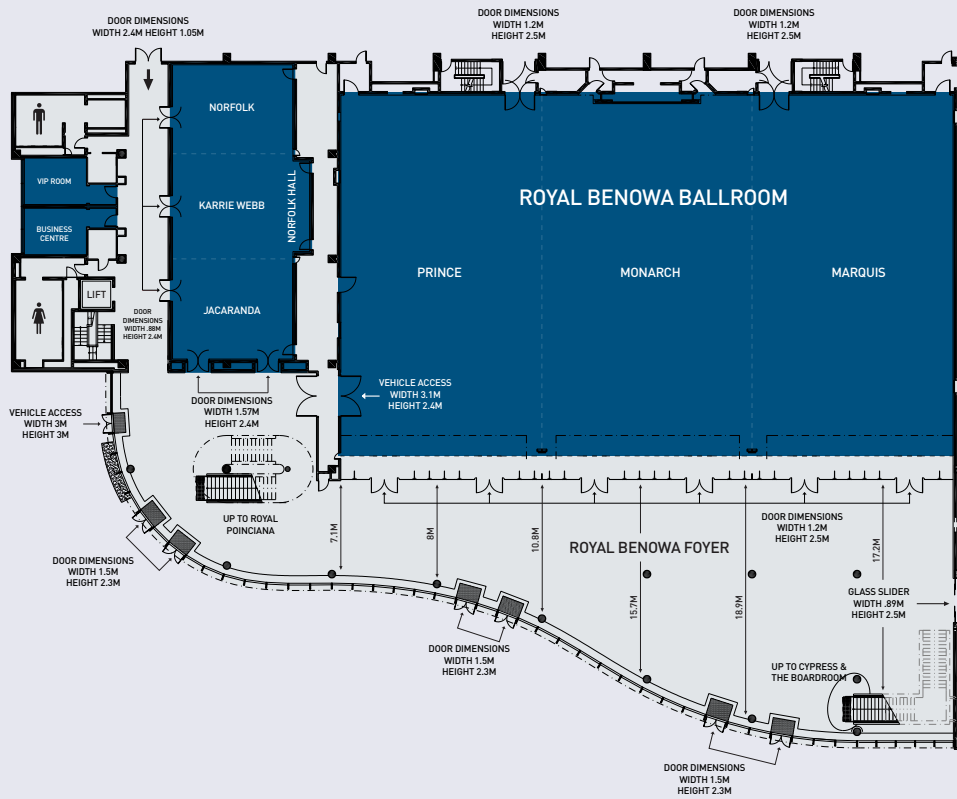

LEVEL 1

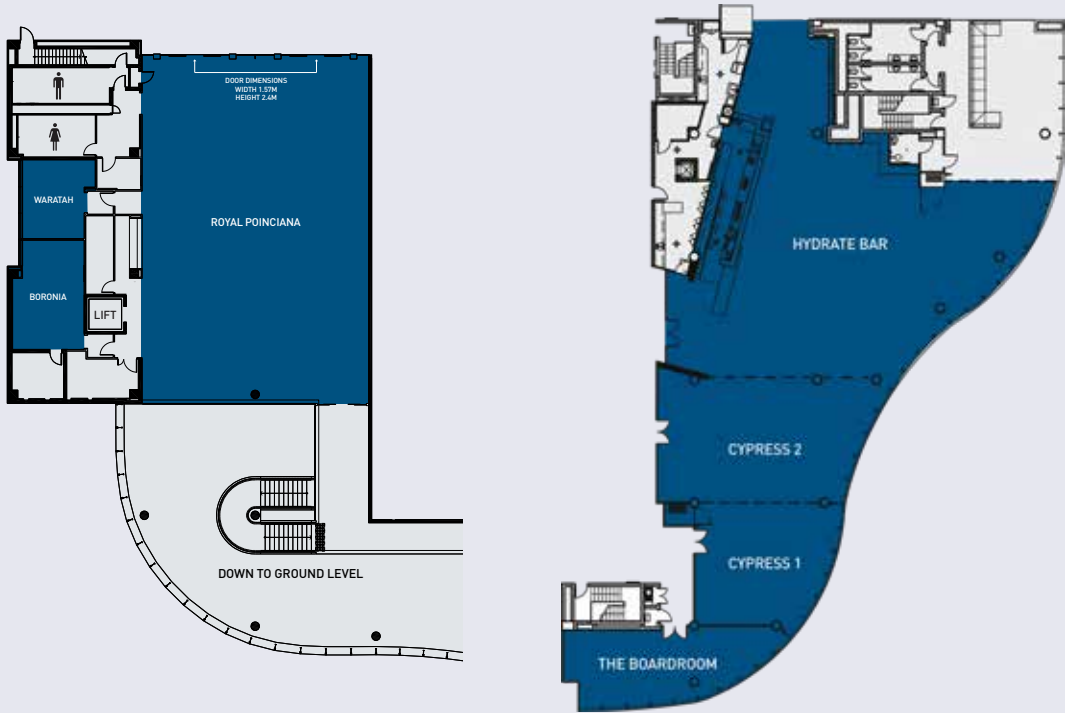

CAPACITIES

ROOM	DIMENSIONS (m x m)	HEIGHT (m)	AREA (m2)	COCKTAIL STYLE	BANQUET STYLE	CABARET STYLE	THEATRE STYLE	C'ROOM STYLE	B'ROOM STYLE	U SHAPE STYLE
Royal Benowa Foyer	-	9.3	1000	1000	450	240	-	-	-	-
Royal Benowa Ballroom (Prince, Monarch, Marquis)	50 x 30	7.7	1500	1500	880	760	1540	972	-	-
Prince	16 x 30	7.7	480	400	280	224	447	276	-	90
Monarch	17 x 30	8.15	510	400	320	256	531	294	-	90
Marquis	16 x 30	7.7	480	400	280	224	447	276	-	90
Norfolk Hall (Norfolk, Karrie Webb, Jacaranda)	10 x 24	4.9	240	200	150	120	200	156	-	-
Norfolk	10 x 7	4.9	70	70	40	32	50	36	21	24
Karrie Webb	11 x 9	4.9	99	90	50	32	60	45	21	24
Jacaranda	10 x 8	4.9	80	70	40	32	50	36	21	24
VIP Boardroom	4.7 x 3.4	3.1	16	-	-	-	-	-	8	-
Business Centre	4 x 5	3.1	20	-	-	-	-	-	8	-
Royal Poinciana	17 x 25	3.4	425	300	220	176	310	204	-	58
Waratah	6 x 5	3.1	30	-	-	-	25	9	12	-
Boronia	7 x 5	3.1	35	-	-	-	30	18	18	15
Cypress I & II	-	3.1	395	200	110	80	135	93	60	51
Cypress I	11 x 9	3.1	99	70	40	32	50	32	21	21
Cypress II	11.8 x 8.3	3.1	94	120	70	46	80	48	30	24
The Boardroom	13 x 5	3.1	65	-	-	-	-	-	16	-
Undercover Tennis Courts	36 x 36	-	1500	1800	640	512	-	-	-	-
Poolside	-	-	-	1000	450	-	-	-	-	-
The Hub	6.5 x 14	3.0	91	60	40	32	48	36	21	24
Fairway Pavillion	-	-	-	500	300	-	540	-	-	-



RACV CITY CLUB

501 Bourke Street
Melbourne, Victoria 3000
1300 139 059
conferencesandevents@racv.com.au

RACV GOLDFIELDS RESORT

1500 Midland Highway,
Creswick, Victoria 3363
(03) 5345 9600
events_goldfields@racv.com.au

RACV CAPE SCHANCK RESORT

Trent Jones Drive,
Cape Schanck, Victoria 3939
(03) 5950 8000
capeschanck_conference@racv.com.au

RACV TORQUAY RESORT

1 Great Ocean Road,
Torquay, Victoria 3228
(03) 5261 1600
events_torquay@racv.com.au

RACV INVERLOCH RESORT

70 Cape Paterson-Inverloch Road,
Inverloch, Victoria 3996
(03) 5674 0000
inverlochevents@racv.com.au

RACV NOOSA RESORT

94 Noosa Drive,
Noosa Heads, Queensland 4567
(07) 5341 6309
eventsnoosa@racv.com.au

RACV HEALESVILLE COUNTRY CLUB & RESORT

122 Healesville-Kinglake Road,
Healesville, Victoria 3777
(03) 5969 9462
healesvilleevents@racv.com.au

RACV HOBART HOTEL

154-156 Collins Street,
Hobart, TAS 7000
(03) 6270 8600
events_hobart@racv.com.au

RACV ROYAL PINES RESORT

Ross Street, Benowa,
Gold Coast, Queensland 4217
(07) 5597 8700
royalpines_sales@racv.com.au

Discover our nine unique destinations at racv.com.au/venues
For multi-property enquiries email meet@racv.com.au